

氣缸連接附件

Y 接頭



Y接頭與氣缸配套表

氣缸系列 附件名稱	SE						SI/SIL/SIF									
	32	40	50	63	80	100	125	32	40	50	63	80	100	125	160	200
F-M10X125Y	●							●								
F-M12X125Y		●							●							
F-M16X150Y			●	●						●	●					
F-M20X150Y					●	●						●	●			
F-M27X200Y							●							●		
F-M36X200Y															●	●

氣缸系列 附件名稱	SG/SGC				SC/SCL/SCF/SU/SUL/SUF						JSI						
	125	160	200	250	32	40	50	63	80	100	32	40	50	63	80	100	125
F-M10X125Y											●						
F-M12X125Y						●											
F-M14X150Y							●						●				
F-M16X150Y								●	●								
F-M18X150Y													●	●			
F-M20X150Y										●	●						
F-M22X150Y																●	●
F-M26X150Y																	●
F-M27X200Y																	●
F-M36X200Y			●	●													
F-M42X200Y					●												

氣缸系列 附件名稱	MI						MPG						
	8	10	12	16	20	25	32	40	6	8	10	12	16
F-M3X050Y									●				
F-M4X070Y	●	●								●	●		
F-M5X080Y												●	●
F-M6X100Y			●	●									
F-M8X125Y					●								
F-M10X125Y						●	●						
F-M12X125Y								●					

成品訂購碼

F-M16X150 Y

附件編號

附件類別

Y: Y接頭

螺紋規格

螺紋牙距

M3: M3
M4: M4
M5: M5
M6: M6
M8: M8
M10: M10
M12: M12
M14: M14
M16: M16
M18: M18
M20: M20
M22: M22
M26: M26
M27: M27
M36: M36
M42: M42

螺紋規格	螺紋牙距
M3	050: 0.5mm
M4	070: 0.7mm
M5	080: 0.8mm
M6	100: 1.0mm
M8/M10/M12	125: 1.25mm
M14/M16/M18	150: 1.5mm
M20/M22/M26	200: 2.0mm
M27/M36/M42	

外部規格

M10及以下

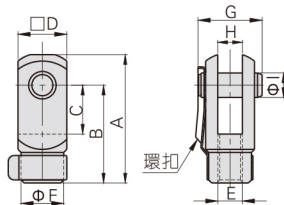

型號符號	A	B	C	D	F
F-M3X050Y	15.5	12	5	6	6
F-M4X070Y	22	16	8	8	7
F-M5X080Y	28	21	10.2	12	10
F-M6X100Y	32	24	12	12	10
F-M8X125Y	42	32	16	16	14
F-M10X125Y	52	40	20	19	18

型號符號	E	G	H	I
F-M3X050Y	M3×0.5	9	3	3
F-M4X070Y	M4×0.7	11.5	4	4
F-M5X080Y	M5×0.8	15.5	6.5	5
F-M6X100Y	M6×1.0	16	6	6
F-M8X125Y	M8×1.25	21	8	8
F-M10X125Y	M10×1.25	25	10	10

M14/M18/M22/M26

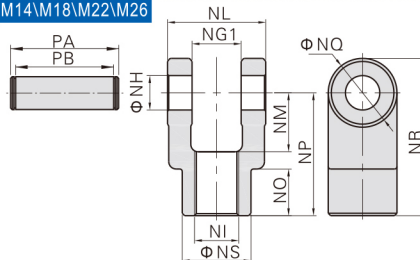

型號符號	NG1	NH	NI	NL	NM
F-M14X150Y	14.2	10	M14×1.5	27.8	19
F-M18X150Y	20.2	14	M18×1.5	39.8	24
F-M22X150Y	30.2	22	M22×1.5	59.8	34
F-M26X150Y	30.2	22	M26×1.5	59.8	34

型號符號	NO	NP	NQ	NR	NS	PA	PB
F-M14X150Y	17	40	22	51	22	34.6	28.8
F-M18X150Y	19	50	28	64	28	47	40.8
F-M22X150Y	20	65	40	85	40	69.2	60.8
F-M26X150Y	20	65	40	85	40	69.2	60.8

其他規格

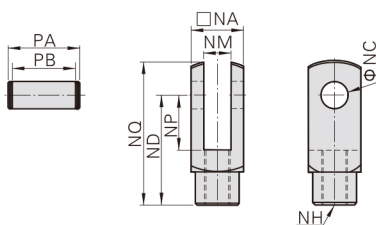

型號符號	NA	NC	ND	NP	NQ
F-M12X125Y	25.4	12	48	24	62
F-M16X150Y	32	16	64	32	80
F-M20X150Y	44.4	20	80	40	102
F-M27X200Y	54	30	110	55	139
F-M36X200Y	70	35	144	73	179
F-M42X200Y	85	40	168	86	211

型號符號	NM	NH	PA	PB
F-M12X125Y	12	M12×1.25	32.4	26.2
F-M16X150Y	16	M16×1.5	39	32.8
F-M20X150Y	20	M20×1.5	53.4	45.2
F-M27X200Y	30	M27×2.0	64.2	54.8
F-M36X200Y	35	M36×2.0	80.2	70.8
F-M42X200Y	40.3	M42×2.0	115	93